

**WML-WMS CODE: 31.8871.97.3**

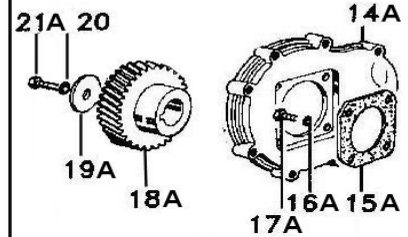

**TML-TTL CODE: 31.8870.97.3**

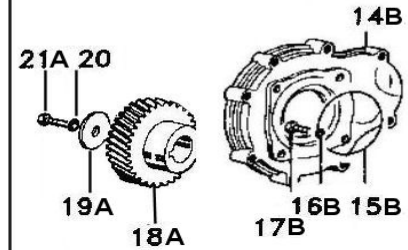

**TTK-KTL-KKL CODE: 31.9110.97.3**

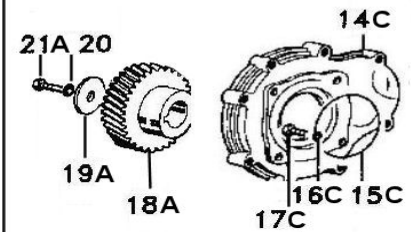

**RA-RB CODE: 31.8855.97.3**

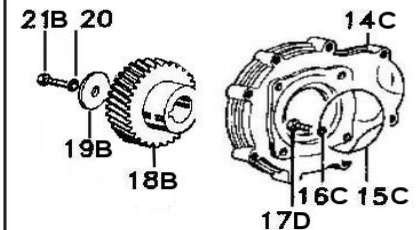

POS.	CODICE PART NO. RÉF.	DENOMINAZIONE - DESCRIPTION - DESCRIPTION	Q.TY	POS.	CODICE PART NO. RÉF.	DENOMINAZIONE - DESCRIPTION - DESCRIPTION	Q.TY
1	806480052	LINGUETTA	1	17C	863328002	VITE (TTK-KTL-KKL)	4
2	801410002	ANELLO ELASTICO	1	17D	863347002	VITE (RA-RB)	4
3	812890002	CUSCINETTO A SFERE	1	18A	311491422	CORONA (TUTTE ECCETTO RA-RB)	1
4	853512002	TAPPO CARICO OLIO	1	18B	311476422	CORONA (RA-RB)	1
5	311495092	SCATOLA RIDUTTORE	1	19A	843620002	ROSETTA (WML-WMS-TML-TTL-TTK-KTL-KKL)	1
6	814574002	DADO	2	19B	311477762	ROSETTA (RA-RB)	1
7	843685002	ROSETTA	2	20	843593002	ROSETTA	1
8	843763002	ROSETTA	4	21A	862210002	VITE (TUTTE TRANNE RA-RB)	1
9	863098002	VITE	4	21B	862131002	VITE (RA-RB)	1
10	838121002	PRIGIONIERO	2	22	824140002	GUARNIZIONE	1
11	311750422	PIGNONE	1	23	852632002	TAPPO	1
13	311268722	GUARNIZIONE	1	24	862752002	VITE	6
14A	311492092	SCATOLA RIDUTTORE (WML-WMS)	1	25	853510002	SPIA OLIO	1
14B	311489092	SCATOLA RIDUTTORE (TM-TTL)	1	26	801297002	ANELLO ELASTICO	1
14C	311256092	SCATOLA RIDUTTORE (TTK-KTL-KKL-RA-RB)	1	27	802189602	ANELLO TENUTA RADIALE	1
15A	311276722	GUARNIZIONE (WML-WMS)	1				
15B	803210002	ANELLO OR (TM-TTL)	1				
15C	803080902	ANELLO OR (TTK-KTL-KKL-RA-RB)	1				
16A	843585002	ROSETTA (WML-WMS)	4				
16B	843642902	ROSETTA (TM-TTL)	4				
16C	824051002	ROSETTA (TTK-KTL-KKL-RA-RB)	4				
17A	862191002	VITE (WML-WMS)	4				
17B	862741002	VITE (TM-TTL)	4				